

Part List

CB36

Unit: inch

No	Picture	Specification	Qty
A		Screw Ø3*1/2"	56
B		Screw Ø3*5/8"	4
C		Screw Ø4*5/8"	2
D		Screw Ø4*1 3/16"	20
E		L Bracket	2
F		Drawer Glides	2
G		Glide Connector	2
H		135° Metal Clip	12
I		Shelf Clip	8
J		Hinges	2
K		Bumper	6

7	Back Panel 	12	Shelf
8	Bottom Panel 	13	Drawer Front
9	Toe kick 	14	Drawer Sides
10	Support Panel 1 	15	Drawer Back
11	Support Panel 2 	16	Drawer Bottom
1	Door 	2	Face Frame
4	Right Face Side Panel 	5	Left Back Side Panel
6	Right Back Side Panel 	3	Left Face Side Panel

Step 1

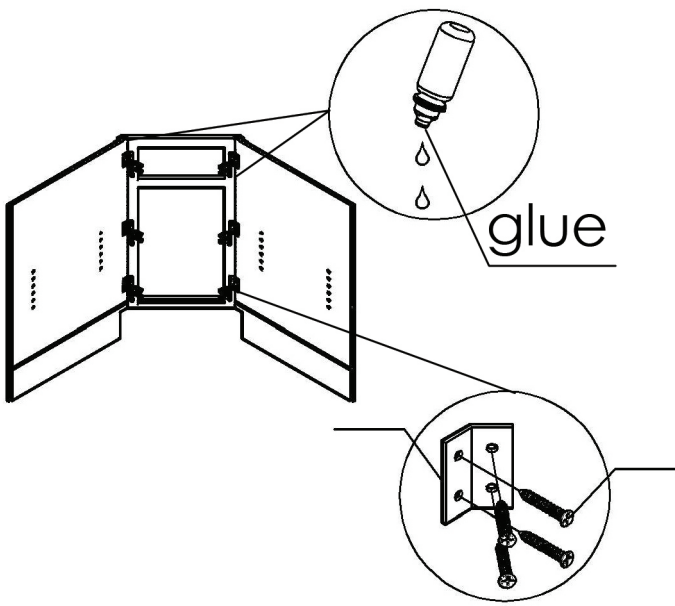

1. Set the face frame face up. Locate your front side panels and slide them into the face frame using the vertical dovetail grooves. Use three metal clips on each side of the face frame to secure everything together.

Step 2

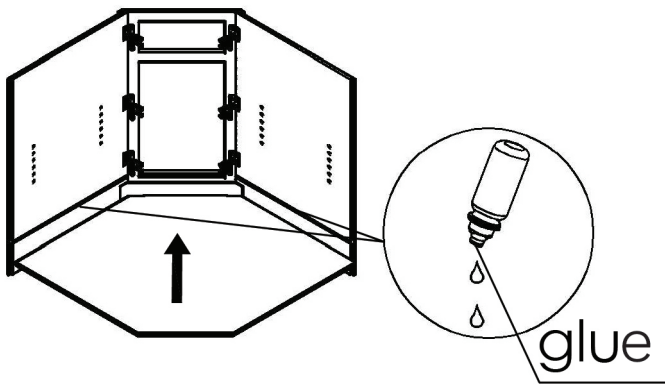

2. Locate the cabinet floor and slide it into the parallel grooves on the front side panels. Make sure it slides into the grooves on the face frame.

Step 3

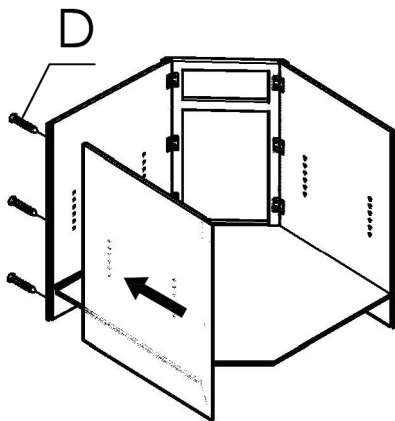

3. Locate the rear side panel and secure it to the cabinet. Make sure the floor board fits into the groove on the panel. Then attach the panel to the cabinet using large screws.

Step 4

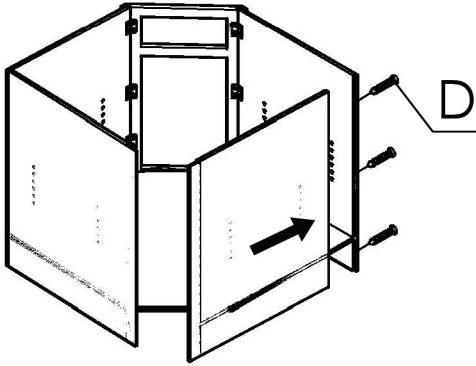

4. Locate the other rear side panel and secure it to the cabinet. Make sure the floor board fits into the groove on the panel. Then attach the panel to the cabinet using large screws.

Step 5

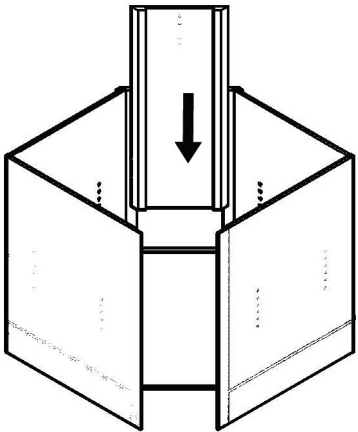

5. Slide the back wall into the inner back side lips between the two back side panels (opposite side of face).

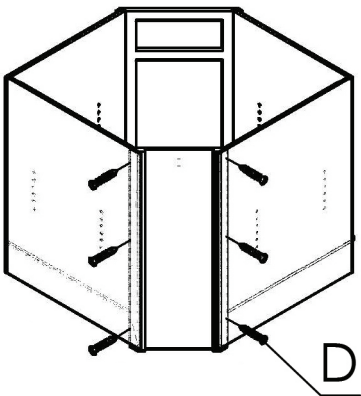

Secure the back side panels to the back panel using large screws in the designated screw holes.

Step 6

1.

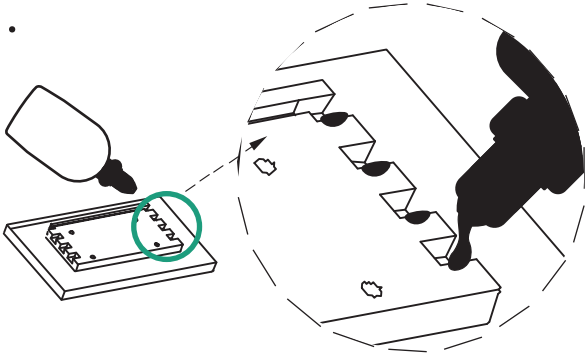

6-1. Set the drawer front face down. Place a dab of glue in each tooth.

2.

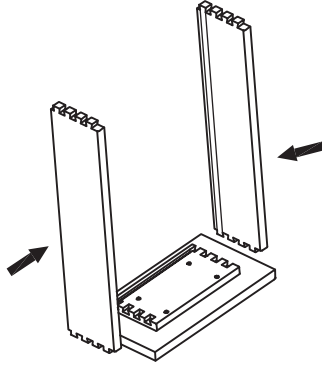

6-2. Using a rubber mallet lightly pound each drawer side into place. Line up the teeth and the grooves on the drawer front to the teeth and grooves on each side (grooves inward).

3.

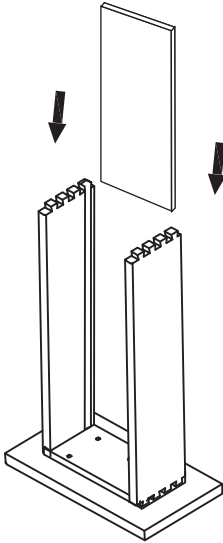

6-3. Slide the drawer floor into the parallel grooves on the inside of the drawer. Make sure it fits into the groove on the drawer front. Be sure to wipe off any excess glue.

4.

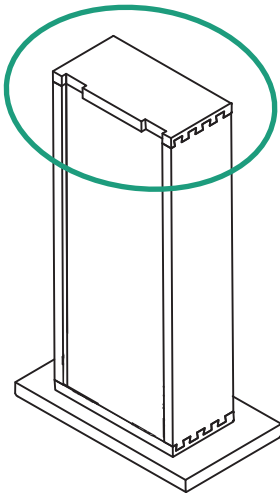

6-4. Place the drawer back (notch side down) teeth inward between the left and right sides of the drawer walls. Interlock the teeth. Lightly pound it into place using a rubber mallet.

Step 7

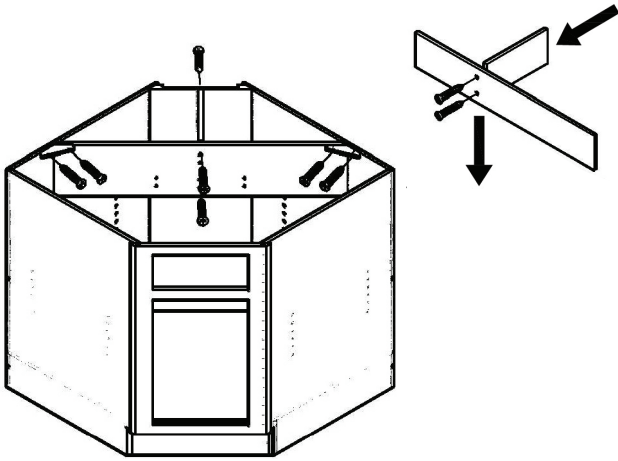

7. Take the cabinet cross beams and place them together using large screws to connect them together. Once together attach it to the back side panels. Use corner brackets to attach it to the back side panels and the back panel.

Step 8

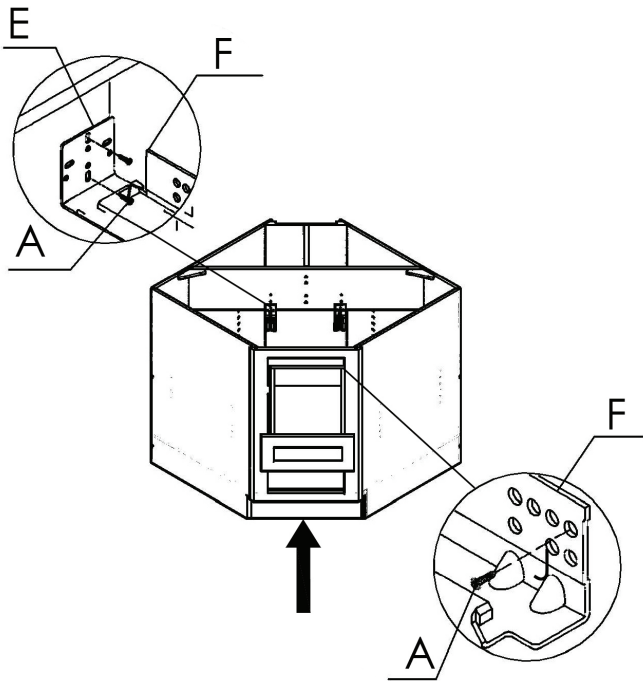

8. Place one L bracket onto the cross beam on the inside of the cabinet using the existing pilot dimples on the beam. Repeat this for the Drawer glide L bracket.

Locate the left and right drawer glides. Slide the back of the glide into the notches on the corresponding L brackets (located on cross beam). The front of the glide should rest on the inside of the face frame. Secure it to the inside of the face using the pre-drilled dimple.

Step 9

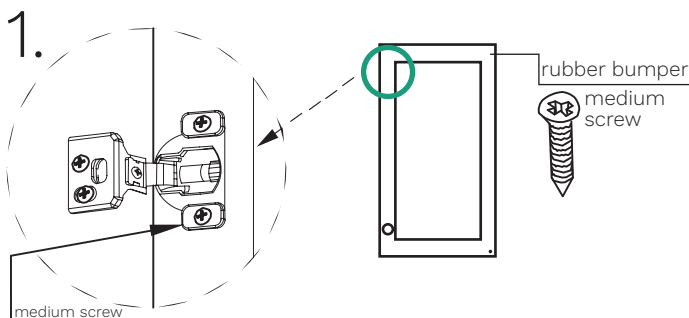

9-1. Place the door face down and set each hinge into place. Line up the corresponding screw holes on the door with the corresponding holes on the hinge. Secure the hinges to the door with two medium screws per hinge. Place one rubber bumper on the inside of each corner (opposite of the hinges).

2.

9-2. Locate the pre-drilled dimple on the inside lip of the face frame. Then drill a 3/4" deep pilot hole with a 3/32 drill bit.

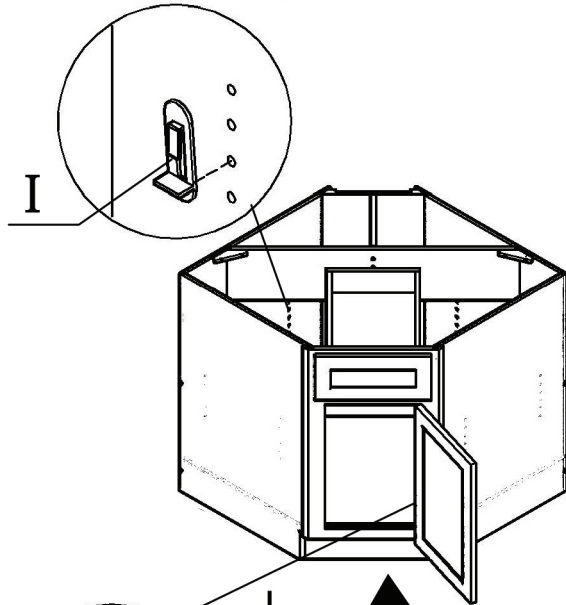

3.

9-3. Line up the corresponding holes on the hinges with the corresponding holes on the face frame and fasten them down using one large screw each. Use a screwdriver to adjust the door position if needed.

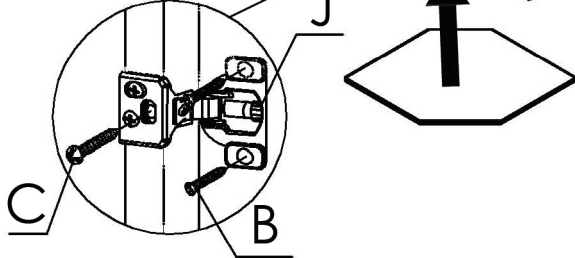

Complete

